

BRAND NEW & VERIFIED



VERIFIED PRODUCT DATASHEET

C9200-24T-E

Cisco Network Hardware Specification, Availability and Quote Reference

Product Model	C9200-24T-E
Document Type	Product Datasheet
Condition	Brand New, Original and Verifieded
Supplier	Layer23-Switch.com

200+ Countries Sold	18,000+ Customers Trusted	\$20M Inventory Available	1-Year Warranty Support
-------------------------------	-------------------------------------	-------------------------------------	-----------------------------------

Need Price or Availability?

View product details, check stock, or request a fast quotation from Layer23-Switch.

[View Product Page & Request a Quote](#)



C9200-24T-E Datasheet

The Cisco C9200-24T-E datasheet provides verified specifications, key features, and application scenarios. This document helps engineers and IT buyers quickly evaluate the C9200-24T-E and integrate it into enterprise or service provider networks with confidence.

[Read More](#) | [Quote](#)



Key Features

Investment Protection

Modular Uplink Flexibility. Unlike fixed-uplink models, this switch lets you scale from 1G to 10G or 25G by simply swapping the module, protecting your hardware investment as bandwidth needs grow.

Business Continuity

Full Hardware Redundancy. Designed for mission-critical uptime with dual field-replaceable power supplies (FRU) and redundant fans, ensuring continuous operations even during component failure.

Enterprise Security

Trustworthy Systems. Protects your network core with AES-128 MACsec encryption, Secure Boot, and Image Signing, meeting strict compliance standards for data integrity and threat defense.

StackWise-160

Simplified Management. Manage up to 8 switches as a single logical unit with 160 Gbps stacking bandwidth. Provides high-speed backplane resiliency and unified control for easier IT operations.

Layer 3 Intelligence

Optimized Traffic Flow. Comes with Network Essentials, enabling advanced routing (OSPF, EIGRP, ISIS) at the access layer to reduce core congestion and improve application latency.

Operational Efficiency

Automated Telemetry. Supports NETCONF/YANG and model-driven telemetry. Reduces OPEX by enabling automated provisioning and real-time health monitoring via Cisco DNA Center or third-party tools.

Catalyst 9200L Access Layer Switch Rear Panel

The switch rear panel includes StackWise connectors, StackPower or XPS connectors, ports, fan modules, and power supply modules.

1	RJ-45 console port	4	Blue Beacon LED
2	Fixed fan modules on C9200L switches	5	MGMT (RJ-45 10/100/1000 management port)
3	Power supply module slots	6	StackWise-80 port connectors

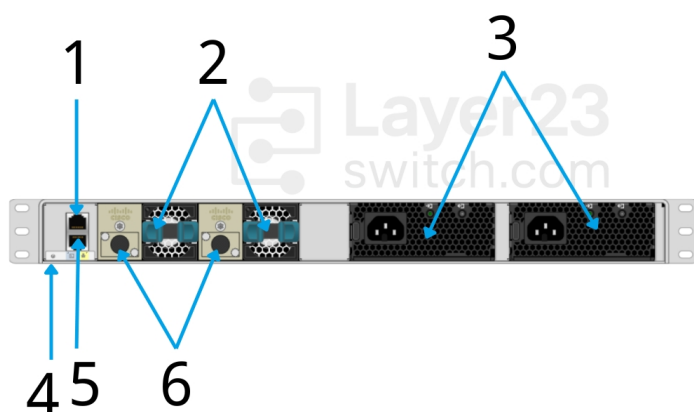

Catalyst 9200L Components Delivered in the Shipping Box

The shipping box contains the model of the switch you ordered and other components needed for installation. Some components are optional, depending on your order.

1	Cisco Catalyst 9200 Series switch ¹ (power supply modules are not displayed)	8	Cable guide
2	AC power cord	9	M4.0 x 20mm Phillips pan-head screw
3	Four rubber mounting feet	10	RJ-45 USB console cable ¹
4	Two 19-inch mounting brackets	11	(Optional) USB console cable ¹

5	4 number-12 pan-head screw	12	(Optional) StackWise cable ¹ (0.5-meter, 1-meter, or 3-meter)
6	4 number-10 pan-head screws	13	Power cord retainer
7	8 number-8 Phillips flat-head screws	-	-

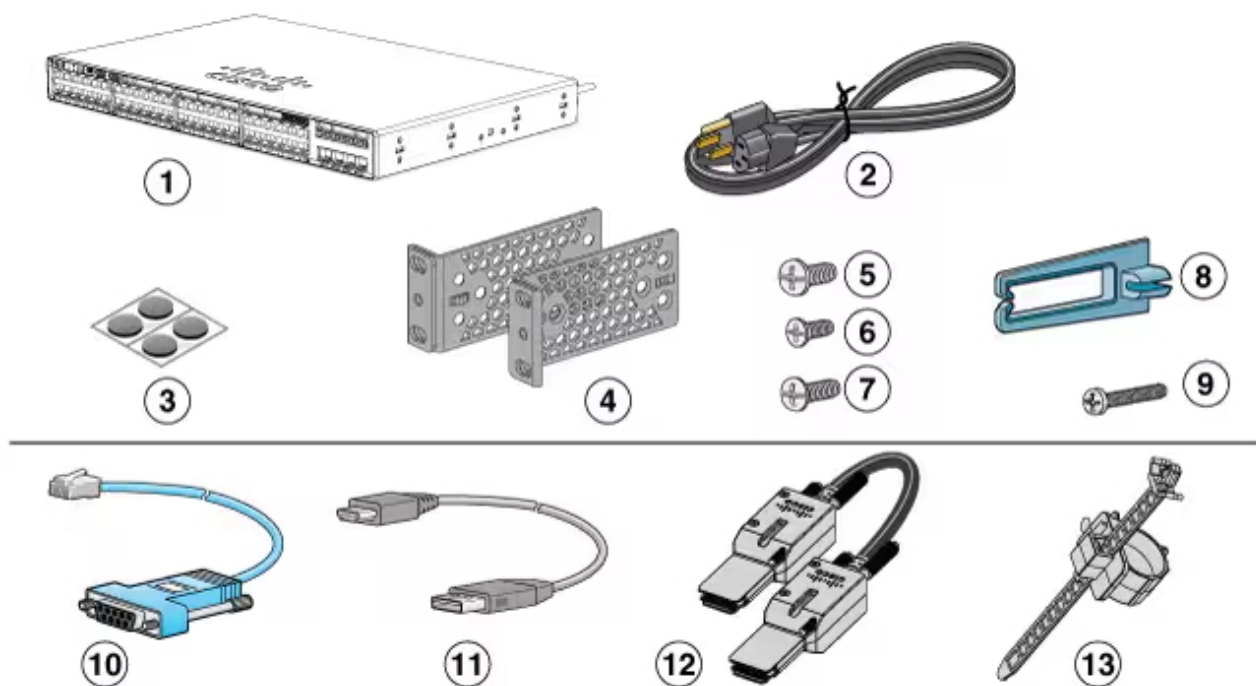

355823

Specification

Parameter	Details	Parameter	Details
Model SKU	C9200-24T-E	Product Family	Cisco Catalyst 9200 Series
Enclosure Type	Rack-mountable - 1U	Software License	Network Essentials
Downlink Ports	24 x 10/100/1000 (Data Only)	Uplink Interface	Modular (4x1G, 4x10G, 2x25G supported)
Switching Capacity	128 Gbps	Forwarding Rate	95.23 Mpps
Stacking Technology	StackWise-160	Stacking Bandwidth	160 Gbps
Stacking Members	Up to 8 Units	Stacking Cable	Optional (C9200-STACK-KIT)
DRAM	4 GB	Flash Memory	4 GB
MAC Address Table	16,000 Entries	Total IPv4 Routes	11,000 (8,000 direct + 3,000 indirect)

Parameter	Details	Parameter	Details
IPv6 Routing Entries	3,000	Multicast Scale	1,000 Groups
ACL Scale Entries	1,500	QoS Scale Entries	1,000
VLAN IDs	4,096	Max Active VLANs	4,096
Switched Virtual Interfaces (SVIs)	512	Jumbo Frames	9198 bytes
Packet Buffer	6 MB	Flexible NetFlow (FNF)	16,000 flow entries
Management Ports	1 x RJ-45 (Ethernet), 1 x RJ-45 (Console), 1 x USB Mini-B (Console)	Storage Interface	1 x USB 2.0 Type A
Power Supply Type	PWR-C6-125WAC (Default)	Power Redundancy	Dual Modular (Field Replaceable)
Power Consumption (No Load)	35W (Typical)	Power Consumption (Full Load)	~50W (Traffic Dependent)
Voltage Range	100 to 240 VAC	Frequency	50 to 60 Hz
Fan System	Dual Replaceable Fans (Fixed airflow)	Fan Redundancy	Yes
Mean Time Between Failures (MTBF)	587,800 Hours	Acoustic Noise (Typical)	42 dBA
Operating Temperature	23°F to 113°F (-5°C to 45°C)	Storage Temperature	-40°F to 158°F (-40°C to 70°C)
Operating Humidity	5% to 90% (Non-condensing)	Operating Altitude	Up to 10,000 ft (3000 m)
Safety Certifications	IEC 60950-1, UL 60950-1, CAN/CSA C22.2 No. 60950-1, EN 60950-1	Electromagnetic Emissions	FCC Part 15 Class A, EN 55032 Class A, CISPR 32 Class A
Height	1.73 in (4.4 cm)	Width	17.5 in (44.5 cm)
Depth	13.8 in (35.0 cm)	Weight	10.38 lb (4.71 kg)

Want to Buy

[Order Now](#) [Get a Quote](#)

Why Layer23-Switch.com

As a leading network hardware supplier, Layer23-Switch.com focuses on original new ICT equipment of Cisco, H3C, Juniper, etc.

200+

Countries we Sold

18,000+

Customers Trusted

\$20,000,000

Inventory Available

50%-98%

Off Global List Price

100%

Safe Online Shopping

Contact Us

- WhatsApp: [+8617181189993](https://wa.me/8617181189993)
- Wechat: [layer23-switch](https://weixin.qq.com/q/layer23-switch)
- Telegram: [layer23_switch](https://t.me/layer23_switch)
- Email: sales@layer23-switch.com

Need Price and Availability for C9200-24T-E?

View product details, request a quote, or check current stock from Layer23-Switch.

[View Product Details & Request a Quote](#)