

BRAND NEW & VERIFIED



VERIFIED PRODUCT DATASHEET

C9200-48P-E

Cisco Network Hardware Specification, Availability and Quote Reference

Product Model	C9200-48P-E
Document Type	Product Datasheet
Condition	Brand New, Original and Verified
Supplier	Layer23-Switch.com

200+ Countries Sold	18,000+ Customers Trusted	\$20M Inventory Available	1-Year Warranty Support
-------------------------------	-------------------------------------	-------------------------------------	-----------------------------------

Need Price or Availability?

View product details, check stock, or request a fast quotation from Layer23-Switch.

[View Product Page & Request a Quote](#)

C9200-48P-E Datasheet

The Cisco C9200-48P-E datasheet provides verified specifications, key features, and application scenarios. This document helps engineers and IT buyers quickly evaluate the C9200-48P-E and integrate it into enterprise or service provider networks with confidence.

[Read More](#) | [Quote](#)



Key Features

Catalyst 9200L Access Layer Switch Rear Panel

The switch rear panel includes StackWise connectors, StackPower or XPS connectors, ports, fan modules, and power supply modules.

1	RJ-45 console port	4	Blue Beacon LED
2	Fixed fan modules on C9200L switches	5	MGMT (RJ-45 10/100/1000 management port)
3	Power supply module slots	6	StackWise-80 port connectors

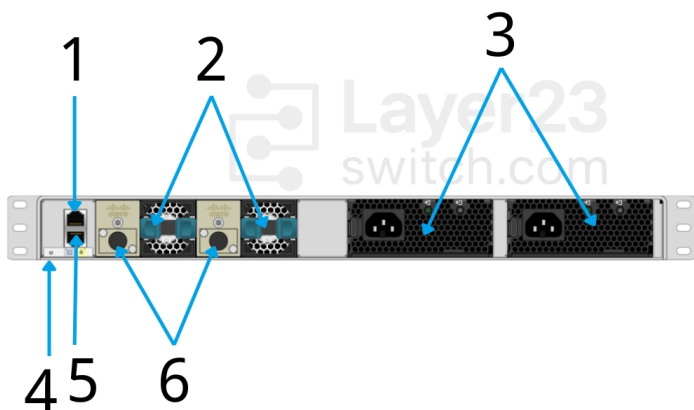

Catalyst 9200L Access Layer Switch Components Delivered in the Shipping Box

The shipping box contains the model of the switch you ordered and other components needed for installation. Some components are optional, depending on your order.

1	Cisco Catalyst 9200 Series switch ¹ (power supply modules are not displayed)	8	Cable guide
2	AC power cord	9	M4.0 x 20mm Phillips pan-head screw
3	Four rubber mounting feet	10	RJ-45 USB console cable ¹
4	Two 19-inch mounting brackets	11	(Optional) USB console cable ¹
5	4 number-12 pan-head screw	12	(Optional) StackWise cable ¹ (0.5-meter, 1-meter, or 3-meter)
6	4 number-10 pan-head screws	13	Power cord retainer
7	8 number-8 Phillips flat-head screws	-	-

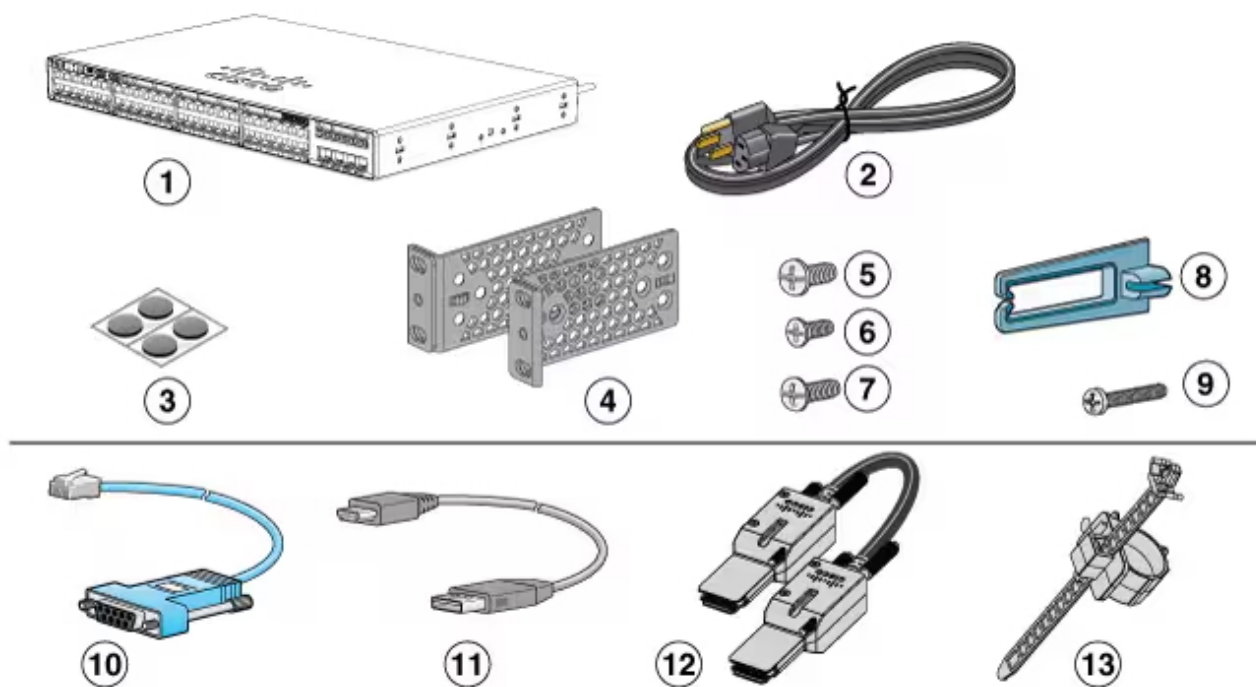

355823

Specification

Parameter	Specification	Parameter	Specification
Switch Model	C9200-48P-E	Downlink Ports	48 × PoE+ RJ-45
Uplink Ports	Modular (4×1 Gbps, 4×10 Gbps, 2×25 Gbps, 2×40 Gbps)	Stacking Bandwidth	160 Gbps (StackWise-160)
Switching Capacity	176 Gbps	Forwarding Rate	130.95 Mpps
Total PoE Budget	1,000 W	Power Supply	PWR-C6-1KWAC AC, FRU, redundant
Fans	Field-replaceable, redundant	License	Network Essentials (E)
MAC Address Table	32,000 entries	IPv4 Routes	14,000 (10,000 direct + 4,000 indirect)
IPv6 Routing Entries	2,000 entries	Multicast Scale	1,000 flows
VLAN IDs	4,096	QoS Scale Entries	1,000
ACL Scale Entries	1,600	Packet Buffer	6 MB
Flexible NetFlow	16,000 flows	DRAM	4 GB
Flash	4 GB	Virtual Networks	4
MTBF	375,570 hours	ENERGY STAR®	No

Want to Buy

[Order Now](#) [Get a Quote](#)

Why Layer23-Switch.com

As a leading network hardware supplier, Layer23-Switch.com focuses on original new ICT equipment of Cisco, H3C, Juniper, etc.

200+ Countries we Sold	18,000+ Customers Trusted	\$20,000,000 Inventory Available	50%-98% Off Global List Price	100% Safe Online Shopping
----------------------------------	-------------------------------------	--	---	-------------------------------------

Contact Us

- WhatsApp: [+8617181189993](https://wa.me/+8617181189993)
- Wechat: [layer23-switch](https://weixin.qq.com/q/layer23-switch)
- Telegram: [layer23_switch](https://t.me/layer23_switch)
- Email: sales@layer23-switch.com

Need Price and Availability for C9200-48P-E?

View product details, request a quote, or check current stock from Layer23-Switch.

[View Product Details & Request a Quote](#)