

BRAND NEW & VERIFIED



VERIFIED PRODUCT DATASHEET

C9200-48T-E

Cisco Network Hardware Specification, Availability and Quote Reference

| | |
|----------------------|---|
| Product Model | C9200-48T-E |
| Document Type | Product Datasheet |
| Condition | Brand New, Original and Verifieded |
| Supplier | Layer23-Switch.com |

| | | | |
|-------------------------------|-------------------------------------|-------------------------------------|-----------------------------------|
| 200+ Countries Sold | 18,000+ Customers Trusted | \$20M Inventory Available | 1-Year Warranty Support |
|-------------------------------|-------------------------------------|-------------------------------------|-----------------------------------|

Need Price or Availability?

View product details, check stock, or request a fast quotation from Layer23-Switch.

[View Product Page & Request a Quote](#)



C9200-48T-E Datasheet

The Cisco C9200-48T-E datasheet provides verified specifications, key features, and application scenarios. This document helps engineers and IT buyers quickly evaluate the C9200-48T-E and integrate it into enterprise or service provider networks with confidence.

[Read More](#) | [Quote](#)



Key Features

48× Gigabit Data Ports

High-density 10/100/1000 Mbps access for workstations and AP uplinks.

Modular Uplink Flexibility

Supports C9200-NM modules: 4×1 G, 2×10 G, 2×25 G, or 2×40 G for future growth.

StackWise-160 Technology

Up to 160 Gbps of stacking bandwidth unites up to 8 switches into a single logical chassis.

Wire-Speed Performance

176 Gbps switching capacity and 130.95 Mpps forwarding for low-latency campus traffic.

Network Essentials License

Core Layer 2 (VLAN, STP), QoS, NetFlow, and automation for simplified operations.

Hot-Swap Redundancy

Field-replaceable AC power supplies and dual fans maximize uptime.

Catalyst 9200L Access Layer Switch Rear Panel

The switch rear panel includes StackWise connectors, StackPower or XPS connectors, ports, fan modules, and power supply modules.

| | | | |
|---|--------------------|---|-----------------|
| 1 | RJ-45 console port | 4 | Blue Beacon LED |
|---|--------------------|---|-----------------|

| | | | |
|---|--------------------------------------|---|--|
| 2 | Fixed fan modules on C9200L switches | 5 | MGMT (RJ-45 10/100/1000 management port) |
| 3 | Power supply module slots | 6 | StackWise-80 port connectors |

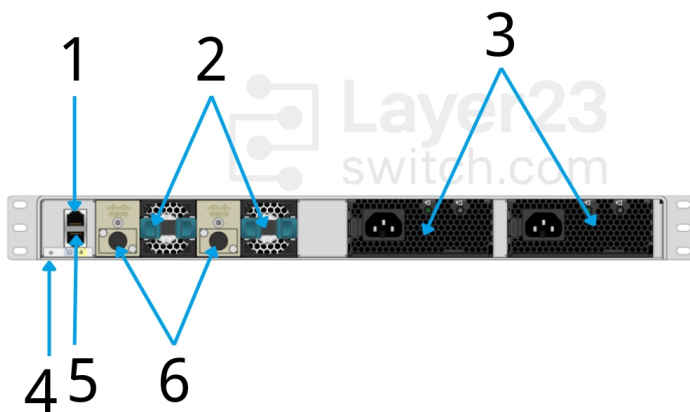

Catalyst 9200L Access Layer Switch Components Delivered in the Shipping Box

The shipping box contains the model of the switch you ordered and other components needed for installation. Some components are optional, depending on your order.

| | | | |
|---|---|----|--|
| 1 | Cisco Catalyst 9200 Series switch ¹ (power supply modules are not displayed) | 8 | Cable guide |
| 2 | AC power cord | 9 | M4.0 x 20mm Phillips pan-head screw |
| 3 | Four rubber mounting feet | 10 | RJ-45 USB console cable ¹ |
| 4 | Two 19-inch mounting brackets | 11 | (Optional) USB console cable ¹ |
| 5 | 4 number-12 pan-head screw | 12 | (Optional) StackWise cable ¹ (0.5-meter, 1-meter, or 3-meter) |
| 6 | 4 number-10 pan-head screws | 13 | Power cord retainer |

| | | | |
|---|--------------------------------------|---|---|
| 7 | 8 number-8 Phillips flat-head screws | - | - |
|---|--------------------------------------|---|---|

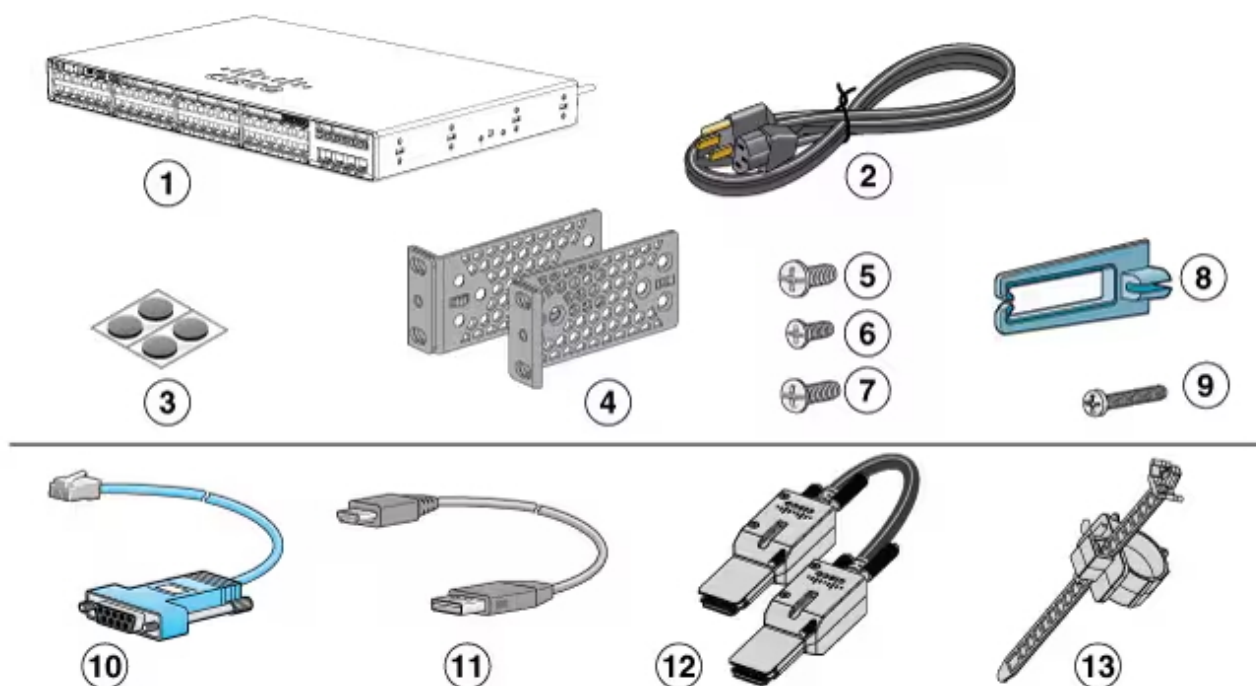

355823

Specification

| Parameter | Specification | Parameter | Specification |
|-----------------------------|---|-------------------------------|------------------------------|
| Switch Model | C9200-48T-E | Downlink Ports | 48 × 1G RJ-45 |
| Uplink Ports | Modular (4×1G/2×10G/2×25G/2×40G) | Stacking Bandwidth | 160 Gbps |
| Switching Capacity | 176 Gbps | Capacity w/ Stacking | 336 Gbps |
| Forwarding Rate | 130.95 Mpps | Forwarding w/ Stacking | 250 Mpps |
| Power Supply | PWR-C6-125WAC AC | Fans | Field-replaceable, redundant |
| License | Network Essentials (E) | MAC Addresses | 32,000 |
| IPv4 Routes | 14,000 (10,000 direct + 4,000 indirect) | IPv4 Routing Entries | 4,000 |
| IPv6 Routing Entries | 2,000 | Multicast Scale | 1,000 flows |
| QoS Scale Entries | 1,000 | ACL Scale Entries | 1,600 |

| Parameter | Specification | Parameter | Specification |
|--------------------------|------------------------------|---------------------------|---------------|
| Packet Buffer | 6 MB | Flexible NetFlow | 16,000 flows |
| DRAM | 4 GB | Flash | 4 GB |
| VLAN IDs | 4,096 | PVST Instances | 128 |
| STP Virtual Ports | 13,000 (Port-VLANs) PVST/MST | SVIs | 512 |
| Jumbo Frames | 9,198 bytes | Wireless Bandwidth | Up to 48 Gbps |
| MTBF | 571,440 hours | — | — |

Want to Buy

[Order Now](#) [Get a Quote](#)

Why Layer23-Switch.com

As a leading network hardware supplier, Layer23-Switch.com focuses on original new ICT equipment of Cisco, H3C, Juniper, etc.

200+ Countries we Sold
18,000+ Customers Trusted
\$20,000,000 Inventory Available
50%-98% Off Global List Price
100% Safe Online Shopping

Contact Us

- WhatsApp: [+8617181189993](https://wa.me/8617181189993)
- Wechat: [layer23-switch](https://www.wechat.com/qrcode/business?business_qr_code=layer23-switch)
- Telegram: [layer23_switch](https://t.me/layer23_switch)
- Email: sales@layer23-switch.com

Need Price and Availability for C9200-48T-E?

View product details, request a quote, or check current stock from Layer23-Switch.

[View Product Details & Request a Quote](#)