

BRAND NEW & VERIFIED



VERIFIED PRODUCT DATASHEET

C9200L-24P-4G-E

Cisco Network Hardware Specification, Availability and Quote Reference

Product Model	C9200L-24P-4G-E
Document Type	Product Datasheet
Condition	Brand New, Original and Verifieded
Supplier	Layer23-Switch.com

200+ Countries Sold	18,000+ Customers Trusted	\$20M Inventory Available	1-Year Warranty Support
-------------------------------	-------------------------------------	-------------------------------------	-----------------------------------

Need Price or Availability?

View product details, check stock, or request a fast quotation from Layer23-Switch.

[View Product Page & Request a Quote](#)



C9200L-24P-4G-E Datasheet

The Cisco C9200L-24P-4G-E datasheet provides verified specifications, key features, and application scenarios. This document helps engineers and IT buyers quickly evaluate the C9200L-24P-4G-E and integrate it into enterprise or service provider networks with confidence.



[Read More](#) | [Quote](#)

Key Features

Enterprise-Class PoE+ Power and High-Density Connectivity

Deliver up to 24 devices with simultaneous PoE+ (30W/port), making the switch perfect for connecting and powering wireless access points, IP phones, and surveillance cameras in offices and classrooms—no need for additional power adapters or outlets.

Simplified Deployment and Centralized Management

Benefit from zero-touch provisioning, Cisco IOS XE automation, and compatibility with Cisco Catalyst Center and Meraki Dashboard. Rapidly deploy and manage multiple switches, automate configuration, and monitor network health in real time.

Reliable Network Uptime with Redundancy and Stacking

Designed for critical business networks, the C9200L-24P-4G-E supports redundant power and fans plus StackWise-80 stacking for up to 8 switches—enabling high availability, rapid failover, and easy expansion as your business grows.

Advanced Security and Policy-Based Access Control

Protect your network and data with features such as MACsec-128 encryption, policy-based segmentation, secure boot, and hardware root-of-trust—ensuring compliance and security for enterprise, retail, and healthcare environments.

Flexible Application for Modern Workplaces and IoT

Ideal for powering not just traditional IT devices, but also smart office endpoints, environmental sensors, digital signage, and building automation—enabling smarter, more efficient workplaces and campuses.

Network Essentials License

Certified by ENERGY STAR®, this model reduces operational costs and environmental impact. Intelligent PoE power allocation, energy-efficient Ethernet, and low-noise operation support green IT initiatives.

Cisco Catalyst 9200L Shipping Box

The shipping box contains the model of the switch you ordered and other components needed for installation. Some components are optional, depending on your order.

1	Cisco Catalyst 9200 Series switch ¹ (power supply modules are not displayed)	8	Cable guide
2	AC power cord	9	M4.0 x 20mm Phillips pan-head screw
3	Four rubber mounting feet	10	RJ-45 USB console cable ¹
4	Two 19-inch mounting brackets	11	(Optional) USB console cable ¹
5	4 number-12 pan-head screw	12	(Optional) StackWise cable ¹ (0.5-meter, 1-meter, or 3-meter)
6	4 number-10 pan-head screws	13	Power cord retainer
7	8 number-8 Phillips flat-head screws	-	-

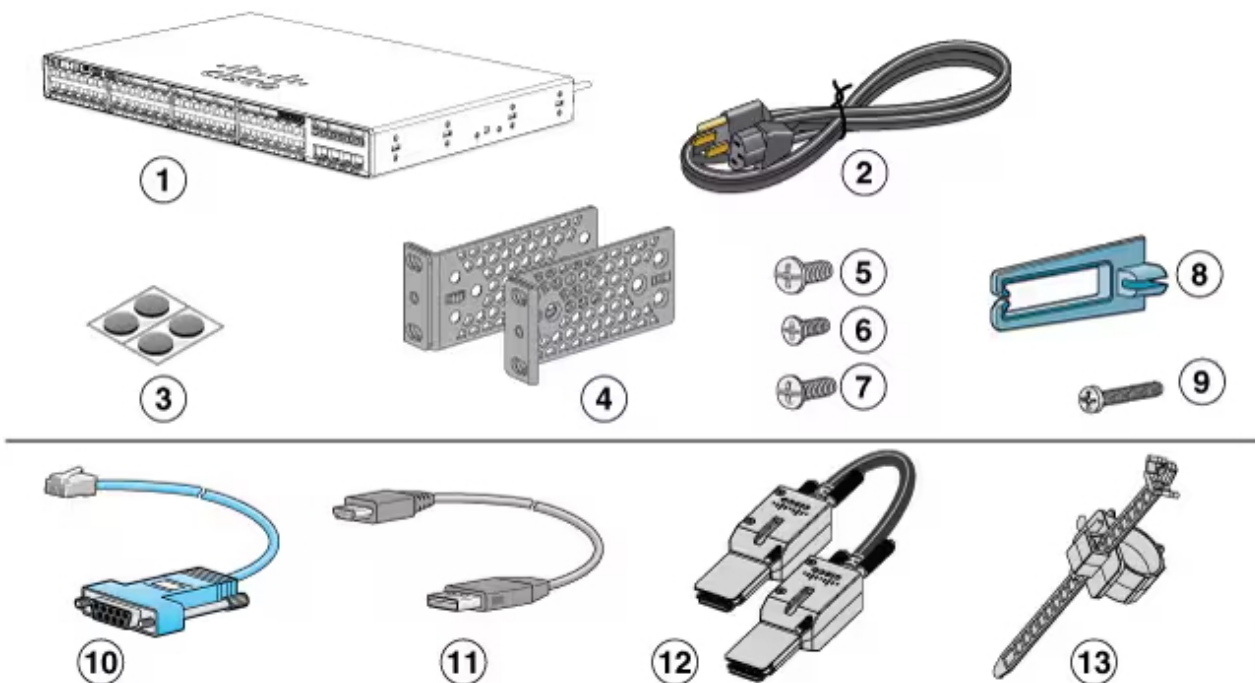

355823

Specification

Parameter	Details	Parameter	Details
Device Description	Catalyst 9200L 24-port PoE+ 4x1G uplink Switch	Software License	Network Essentials
Total Ports	28 Ports	Downlink Ports	24x 10/100/1000 Mbps PoE+
Uplink Ports	4x 1 Gigabit Ethernet SFP (Fixed)	PoE Standard	IEEE 802.3at PoE+
Available PoE Power	370W (with default PWR-C5-600WAC)	PoE Capacity	Full PoE+ capable
Switching Capacity	56 Gbps	Forwarding Rate	41.67 Mpps
Stacking Bandwidth	80 Gbps	Stacking Support	StackWise-80 (Up to 8 members)
DRAM	2 GB	Flash Memory	4 GB
MAC Address Table	16,000 entries	Total IPv4 Routes	11,000 (8,000 direct + 3,000 indirect)
IPv4 Routing Entries	3,000	IPv6 Routing Entries	1,500
VLAN IDs	4096	Packet Buffer	6 MB
Jumbo Frames	9198 bytes	Flexible NetFlow	16,000 flows
Dimensions (H x W x D)	4.4 x 44.5 x 28.8 cm (1.73 x 17.5 x 11.3 in)	Weight	4.71 kg (10.38 lb)
Mounting	Rack Mount (1 RU)	MTBF	392,210 hours
Operating Temperature	-5°C to +45°C (up to 5000 ft)	Storage Temperature	-40°C to +70°C
Operating Humidity	5% to 90% noncondensing	Acoustic Noise	42 dB (Typical) / 45 dB (Max)
Default Power Supply	PWR-C5-600WAC	Power Redundancy	Dual Field-Replaceable (FRU)
Power Consumption (No PoE)	48.47W (100% Traffic)	Voltage Range	100 to 240 VAC, 50 to 60 Hz
Fans	Fixed Redundant	Safety Compliance	UL 60950-1, IEC 60950-1, EN 60950-1

Want to Buy

[Order Now](#) [Get a Quote](#)

Why Layer23-Switch.com

As a leading network hardware supplier, Layer23-Switch.com focuses on original new ICT equipment of Cisco, H3C, Juniper, etc.

200+ Countries we Sold	18,000+ Customers Trusted	\$20,000,000 Inventory Available	50%-98% Off Global List Price	100% Safe Online Shopping
----------------------------------	-------------------------------------	--	---	-------------------------------------

Contact Us

- WhatsApp: [+8617181189993](https://wa.me/8617181189993)
- Wechat: [layer23-switch](https://weixin.qq.com/q/layer23-switch)
- Telegram: [layer23_switch](https://t.me/layer23_switch)
- Email: sales@layer23-switch.com

Need Price and Availability for C9200L-24P-4G-E?

View product details, request a quote, or check current stock from Layer23-Switch.

[View Product Details & Request a Quote](#)