

BRAND NEW & VERIFIED



VERIFIED PRODUCT DATASHEET

C9200L-24T-4X-E

Cisco Network Hardware Specification, Availability and Quote Reference

Product Model	C9200L-24T-4X-E
Document Type	Product Datasheet
Condition	Brand New, Original and Verifieded
Supplier	Layer23-Switch.com

200+ Countries Sold	18,000+ Customers Trusted	\$20M Inventory Available	1-Year Warranty Support
-------------------------------	-------------------------------------	-------------------------------------	-----------------------------------

Need Price or Availability?

View product details, check stock, or request a fast quotation from Layer23-Switch.

[View Product Page & Request a Quote](#)

C9200L-24T-4X-E Datasheet

The Cisco C9200L-24T-4X-E datasheet provides verified specifications, key features, and application scenarios. This document helps engineers and IT buyers quickly evaluate the C9200L-24T-4X-E and integrate it into enterprise or service provider networks with confidence.

[Read More](#) | [Quote](#)



Key Features

Catalyst 9200L Access Layer Switch Rear Panel

The switch rear panel includes StackWise connectors, StackPower or XPS connectors, ports, fan modules, and power supply modules.

1	RJ-45 console port	4	Blue Beacon LED
2	Fixed fan modules on C9200L switches	5	MGMT (RJ-45 10/100/1000 management port)
3	Power supply module slots	6	StackWise-80 port connectors

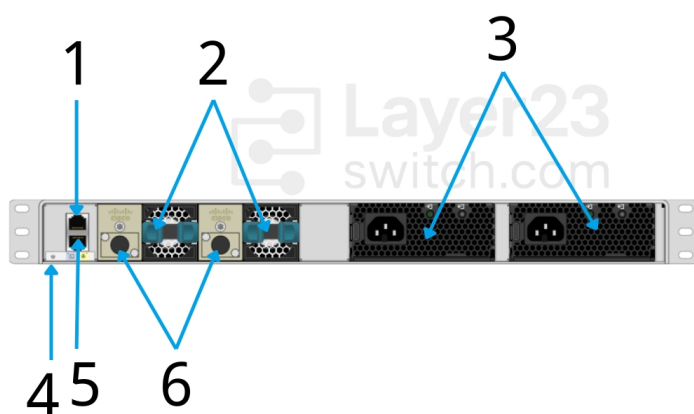

Catalyst 9200L Access Layer Switch Components Delivered in the Shipping Box

The shipping box contains the model of the switch you ordered and other components needed for installation. Some components are optional, depending on your order.

1	Cisco Catalyst 9200 Series switch ¹ (power supply modules are not displayed)	8	Cable guide
2	AC power cord	9	M4.0 x 20mm Phillips pan-head screw
3	Four rubber mounting feet	10	RJ-45 USB console cable ¹
4	Two 19-inch mounting brackets	11	(Optional) USB console cable ¹
5	4 number-12 pan-head screw	12	(Optional) StackWise cable ¹ (0.5-meter, 1-meter, or 3-meter)
6	4 number-10 pan-head screws	13	Power cord retainer
7	8 number-8 Phillips flat-head screws	-	-

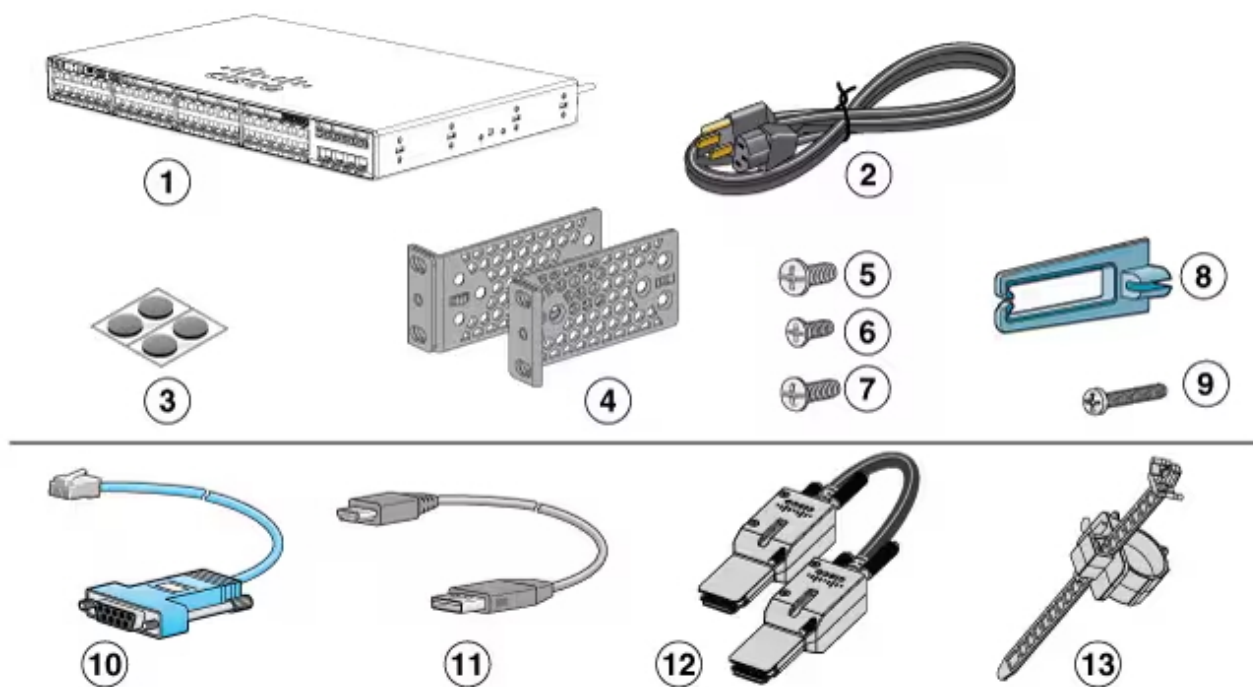

355823

Specification

Parameter	Specification	Parameter	Specification
Product Number	C9200L-24T-4X-E	Description	24-Port Gigabit Data Switch, 4x10G SFP+ Uplinks, Network Essentials
Downlink Ports	24x10/100/1000 Mbps RJ-45	Uplink Ports	4x10 Gbps SFP+
Switching Capacity	128 Gbps	Forwarding Rate	95.23 Mpps
Stack Capacity	208 Gbps (with StackWise-80)	Stacking Module	C9200L-STACK-KIT
Stacking Bandwidth	80 Gbps	Power Supply	PWR-C5-125WAC, fixed, redundant
Fans	2 fixed, redundant	DRAM / Flash	2 GB / 4 GB
MAC Table	16,000 entries	VLAN IDs	4,096
MTBF	525,990 hours	Dimensions (HxWxD)	1.73"×17.5"×11.3" / 1.73"×17.5"×12.9" (with FEP & fan)
Weight	9.59 lbs (4.35 kg)	Operating Temp.	-5 °C to +45 °C
Storage Temp.	-40 °C to +70 °C	Humidity	5%-90% non-condensing
Console Port	1xRJ-45 & USB-C	Mgmt Interface	1xEthernet (4-pair Cat 5 UTP)
License	Network Essentials	Energy Rating	ENERGY STAR® certified

Parameter	Specification	Parameter	Specification
PoE Capability	None (data only)	Layer 3 Features	Static routing, RIP, OSPF

Want to Buy

[Order Now](#) [Get a Quote](#)

Why Layer23-Switch.com

As a leading network hardware supplier, Layer23-Switch.com focuses on original new ICT equipment of Cisco, H3C, Juniper, etc.

200+ Countries we Sold **18,000+** Customers Trusted **\$20,000,000** Inventory Available **50%-98%** Off Global List Price **100%** Safe Online Shopping

Contact Us

- WhatsApp: [+8617181189993](tel:+8617181189993)
- Wechat: [layer23-switch](https://www.wechat.com/qrcode/index?scan_qrcode_action=scan_qrcode)
- Telegram: [layer23_switch](https://t.me/layer23_switch)
- Email: sales@layer23-switch.com

Need Price and Availability for C9200L-24T-4X-E?

View product details, request a quote, or check current stock from Layer23-Switch.

[View Product Details & Request a Quote](#)